

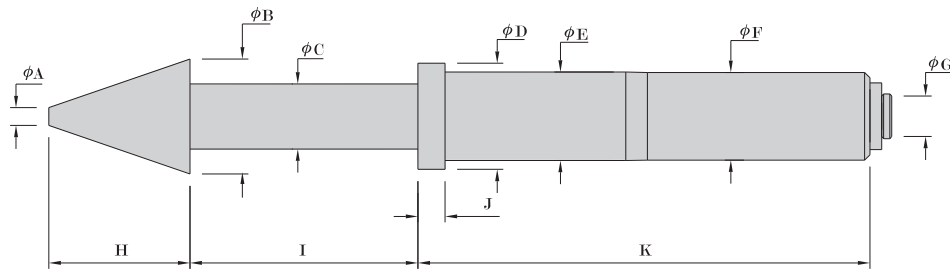

SERIES PRECISION PROBES

m.m. (Dimensions in millimeter)



Recommended Hole Size	Full Stroke Spring Force ($\pm 20\%$)	2/3 Stroke Spring Force ($\pm 20\%$)	Suitable For
5.00mm	300g	200g	QCP-15M3-23L
5.00mm	350g	290g	QCP-10-16L QCP-101-16L QP-25 QP-111

(For Loaded Board)

Spec Type	ϕA	ϕB	ϕC	ϕD	ϕE	ϕF	ϕG	H	I	J	K	O.D.PCB
	I1-6.0	1.00	6.00	3.67	6.00	5.00	4.95	2.48	7.90	20.60	1.50	
GP-2J	1.00	6.50	3.68	6.00	5.00	4.95	2.53	7.80	13.80	1.00	25.00	1.30/1.35mm